

Symbols of PPP-V U3 FAKRO:

No.	(SxH)	(-h)	(h2)
02	55x98 (547x970)	55,6	27,8
03	66x98 (657x970)	55,6	27,8
04	66x118 (657x1170)	69,7	34,9
05	78x98 (777x970)	55,6	27,8
06	78x118 (777x1170)	69,7	34,9
07	78x140 (777x1390)	85,3	42,7
08	94x118 (937x1170)	69,7	34,9
09	94x140 (937x1390)	85,3	42,7
10	114x118 (1137x1170)	69,7	34,9
11	114x140 (1137x1390)	85,3	42,7
12	134x98 (1337x970)	55,6	27,8
13	78x160 (777x1591)	99,4	49,8
14	66x140 (657x1390)	85,3	42,7
15	94x98 (937x970)	55,6	27,8
16	55x118 (547x1170)	69,7	34,9
17	134x140 (1337x1390)	85,3	42,7
18	134x118 (1337x1170)	69,7	34,9
20	114x98 (1137x970)	55,6	27,8
48	46x98 (457x970)	55,6	27,8
49	48x98 (477x970)	55,6	27,8
50	114x160 (1137x1390)	85,3	42,7
80	94x160 (937x1591)	99,4	49,8
81	66x160 (657x1591)	99,4	49,8
82	134x160 (1337x1591)	99,4	49,8

Note: Table of standard windows Fakro is only available on website www.fakro

15° - 55°



MOUNTING DEPTH

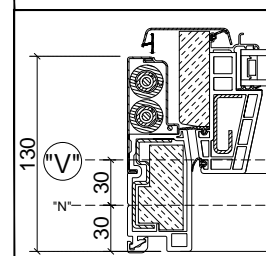

- 1-Water draining gutter FAKRO
- 2-Polyurethane insulating wedge
- 3-Tile supporting profile
- 4-XDP FAKRO vapour permeable collar
- 5-Tress made of sheep wool FAKRO (XDP)
- 6-Blocks made of sheep wool FAKRO (XDP)
- 7-EZV-A FAKRO flashing upper element
- 8-XLC internal lining element FAKRO
- 10-PPP-V MAX pivot window FAKRO
- 12-EZV-A FAKRO flashing side element
- 15-EZV-A FAKRO flashing lower element
- 17-Rafter
- 38-Installation bracket FAKRO
- 109-XDS air-tight flashing FAKRO

FAKRO

PPP-V MAX U3	EZV-A	TILE	XLC
15° - 55°	15° - 90°	25° - 65°	

Vertical and horizontal cross-section:
PPP-V MAX U3 roof window with
EZV-A flashing

FORMAT: A3
SCALE: 1:10/1:5
DATE: 05.2022

Warning! The present drawing is for informational-demonstrative purposes only and as such cannot constitute a basis for performance. All dimensions presented in this drawing should be verified on site. Because of the fact that the drawing is a schematic one, FAKRO shall not assume any responsibility for the actual installation quality on the roof. This drawing is FAKRO's property and cannot be published or used publicly without our written consent.