

Symbols of PTP U4 FAKRO:

No.	(SxH)	(-a)
01	55x78	547x770 20,1
02	55x98	554x970 27,1
03	66x98	657x970 27,1
04	66x118	657x1170 34,2
05	78x98	777x970 27,1
06	78x118	777x1170 34,2
07	78x140	777x1390 42,0
08	94x118	937x1170 34,2
09	94x140	937x1390 42,0
10	114x118	1137x1170 34,2
11	114x140	1137x1390 42,0
12	134x98	1337x970 27,1
13	78x160	777x1590 49,1
14	66x140	657x1390 42,0
15	94x98	937x970 27,1
16	55x118	547x1170 34,2
17	134x140	1337x1390 42,0
18	134x118	1337x1170 34,2
20	114x98	1137x970 27,1
22	66x78	657x770 20,1
23	78x78	777x770 20,1
24	94x78	937x770 20,1
25	114x78	1137x770 20,1
26	134x78	1337x770 20,1
32	66x60	657x590 20,1
33	78x60	777x590 20,1
34	94x60	937x590 20,1
35	114x60	1137x590 20,1
36	134x60	1337x590 20,1
47	48x78	477x770 20,1
49	48x98	477x970 27,1
80	94x160	937x1590 49,1

Note: Table of standard windows Fakro is only available on website www.fakro

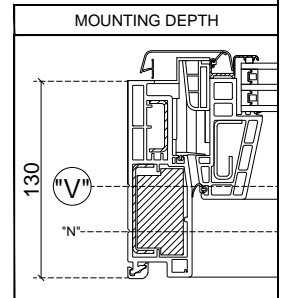

- 4-XDP FAKRO vapour permeable collar
- 5-Tress made of sheep wool FAKRO (XDP)
- 6-Blocks made of sheep wool FAKRO (XDP)
- 8-XLC-P internal lining element FAKRO
- 17-Rafter
- 38-Installation bracket
- 109-XDS-P air-tight flashing FAKRO
- 170-ESV flashing side element FAKRO
- 171-ESV flashing upper element FAKRO
- 172-ESV flashing lower element FAKRO
- 887-PTP U4 aluminium clad plastic window FAKRO

	PTP U4	ESV	BITUMINOUS ROOFING	XLC-P
Vertical and horizontal cross-section: PTP U4 aluminium clad plastic window FAKRO with flashing for tiles roofing materials	15° - 90°	15° - 90°	25° - 65°	
	FORMAT: A3	SCALE: 1:10/1:5	DATE: 03.2022	

Warning! The present drawing is for informational-demonstrative purposes only and as such cannot constitute a basis for performance. All dimensions presented in this drawing should be verified on site. Because of the fact that the drawing is a schematic one, FAKRO shall not assume any responsibility for the actual installation quality on the roof.